



WBK1600
FLEXI FIT



HARDWARE PACK



#32 M10X90 Allen Bolt (Qty3)

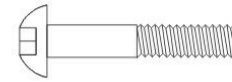

#30 M6X28 Allen Bolt (Qty6)



#33 M10X72 Allen Bolt (Qty2)

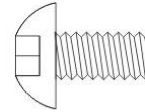

#28 M8X16 Allen Bolt (Qty6)

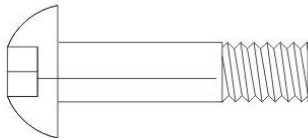

#35 M10X42 Allen Bolt (Qty2)

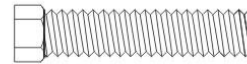

#29 M6X35 Hex Bolt (Qty4)



#36 M6X52 Allen Bolt (Qty2)

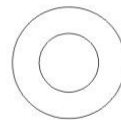

#27Φ10 Washer (Qty16)



#26Φ8 Washer (Qty6)



#37 M10 Aircraft Nut (Qty9)



#31 M6 Aircraft Nut (Qty8)



#25Φ6 Washer (Qty20)

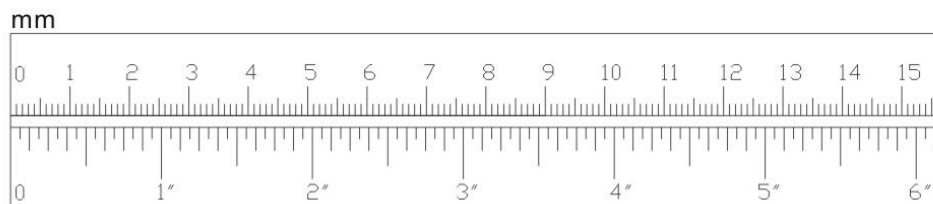

ASSEMBLY INSTRUCTION

Tools Required for Assembling the Machine: Adjustable wrench and Allen wrench

Note: It is strongly recommended two or more people assemble this machine to avoid possible injury.

STEP 1 (See Diagram1)

- A. Attach the Front Base Support (#7) to Front Vertical Support (#1). Secure it with two M10 x 42mm Allen Bolts (#35), four Φ 10 Washers (#27) and two M10 Aircraft Nuts (#37).
- B. Attach the Seat Support (#2) to the Front Vertical Support (#1). Align the holes secure it with one M10 x 90mm Allen Bolts (#32), two Φ 10 Washers (#27) and one M10 Aircraft Nut (#37). Insert the **Lock Pin (#11)** through the hole on the bracket of the Front Vertical Support (#1) and Seat pad Support (#2).
- C. Attach the Rear Base Support (#3) to the Seat Pad Support (#2). Secure it with two M10 x 90mm Allen Bolts (#32), four Φ 10 Washers (#27) and two M10 Aircraft Nuts (#37).

DIAGRAM 1

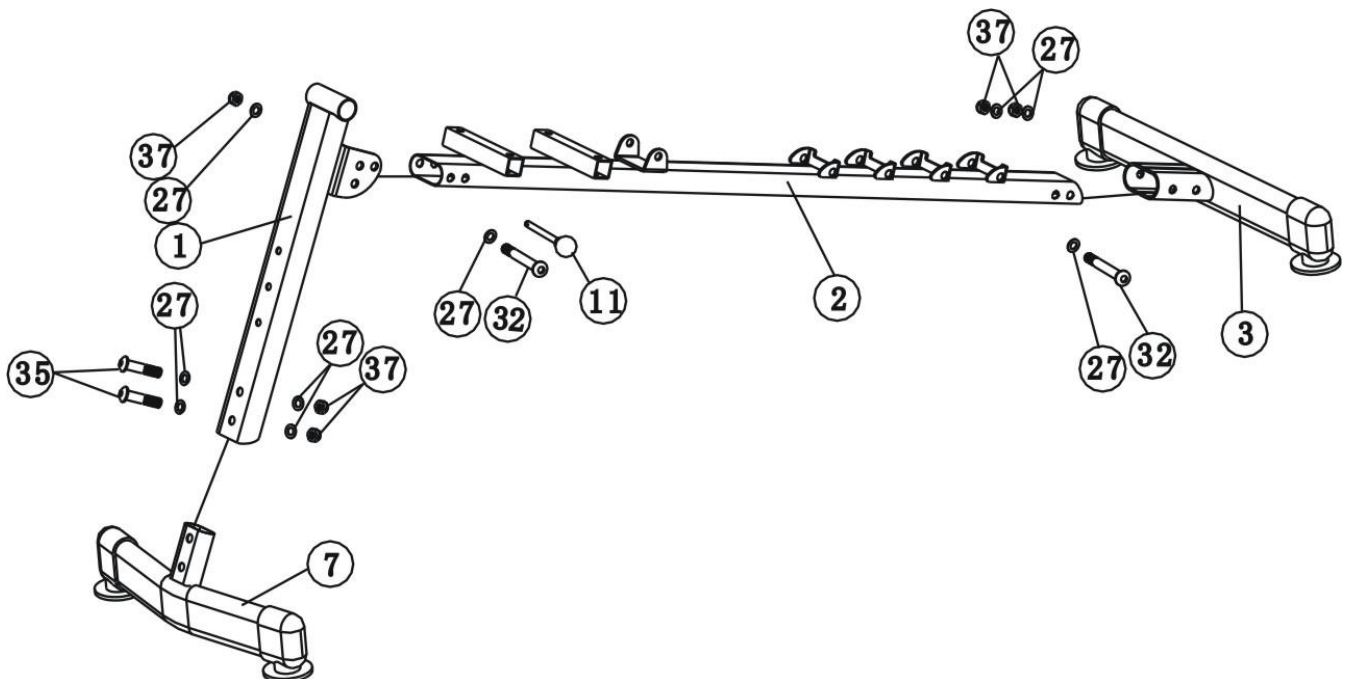

STEP 2 (See Diagram 2)

- D. Attach Backrest Incline Support (#5) to the Bracket on the Backrest Support Frame (#8), Align the hole and secure with one **M10*72MM Allen Bolt (#33)**, two Ø10MM Washers (#27) and one M10 Aircraft Nut (#37).
- E. Attach the Backrest Pad (#16) to the Backrest Support Frame (#8). Align the holes and secure with four M8 x 16mm Allen Bolts (#28) and four Ø8mm Washers (#26).
- F. Attach the Backrest Pad (#17) to the Backrest Support Frame (#8). Align the holes and secure with two M8 x 16mm Allen Bolts (#28) and two Ø8mm Washers (#26).

DIAGRAM 2

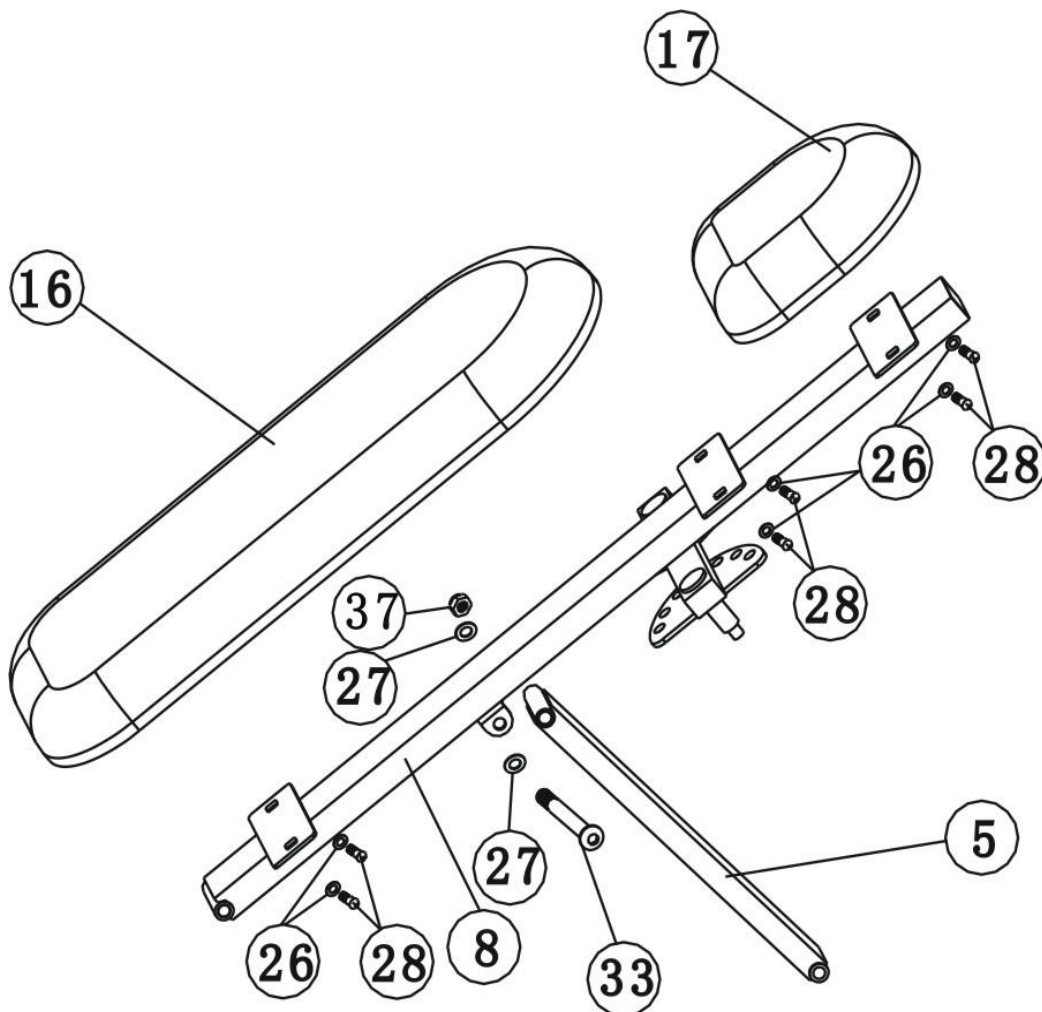

STEP 3 (See Diagram 3)

- G. Attach the Backrest Support Frame (#8) to the U Shaped Bracket on the mid of the Seat Pad Support Frame (#2), Align the hole and secure with one M10X72MM Allen Bolt (#33), two Ø10mm Washers (#33) and one M10 Aircraft Nut (#37).
- H. Attached the Backrest Incline Support to the U-Shaped Bracket on the Seat Support Frame, adjust to the desired incline and insert the Lock Pin (#11).
- I. Attach the Butterfly Frame (#9) to the two Angle Select Plates on the back of the Backrest Support Frame (#8). Secure each of them with one Ø10mm Washer (#27) and one M10 Aircraft Nut (#37). Screw the two M18 Lock Knobs (#12) through the hole on the side of the Butterfly Frame (#9) and the hole on the Angle Select Plate, get the desired angle of the two Butterfly Frames (#9) and tighten.
- J. Attach the Seat Pad (#15) to the Seat Support Frame (2), align the holes and secure with four M6X35MM Hex Bolts (#29) and four Ø6MM Washers (#25).

Diagram 3

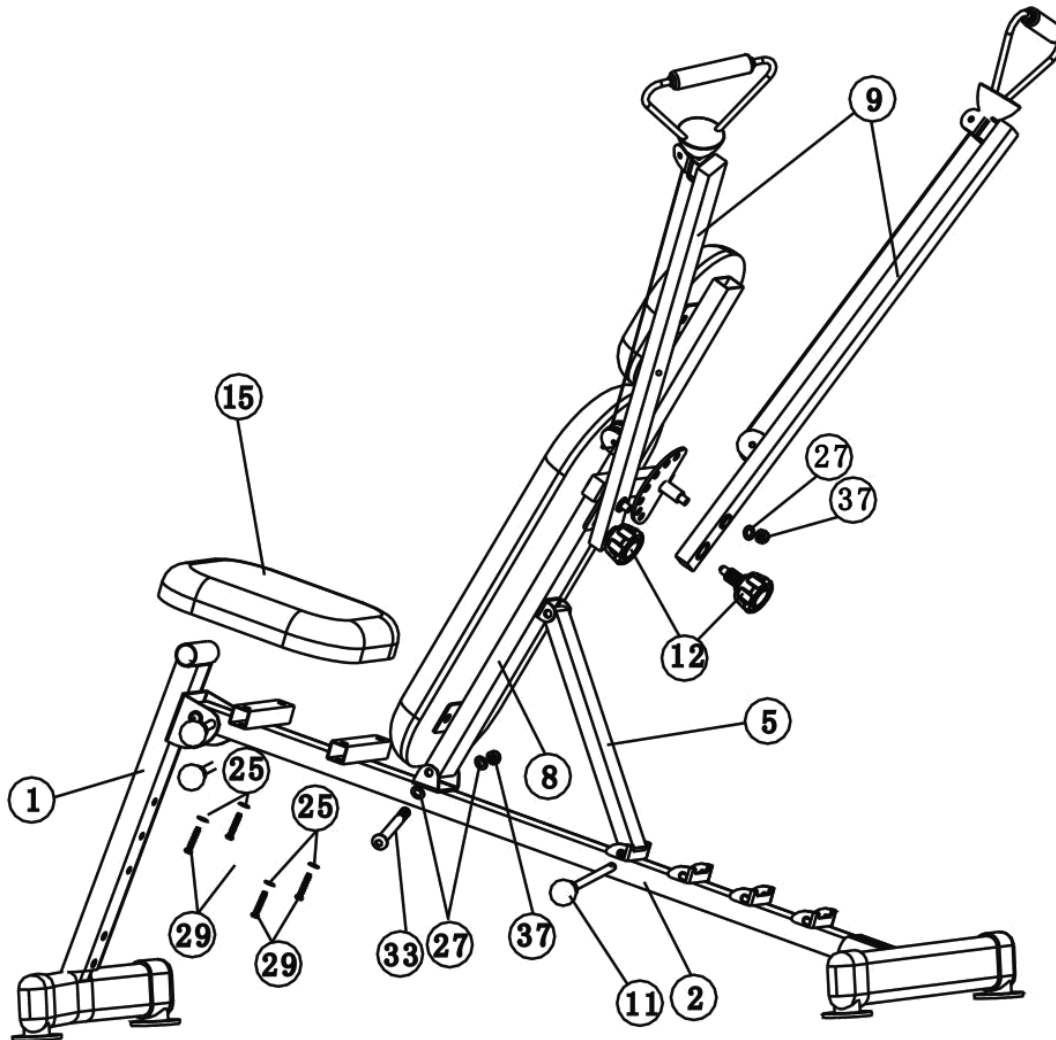

STEP 4 (See Diagram 4)

K. Attach the short Foam Roll Tube (#4) to the Front Vertical Support (#1). Use the Knob (#23) to secure the tube at the selected hole. Push two Foam Rolls (#18) onto each end of the Foam Roll Tube (#4).

L. Insert the Long Foam Roll Tube (#6) halfway through the hole on the top of the Front Vertical Support (#1). Push two Foam Rolls (#18) from each side of the Long Foam Roll Tube (#6).

DIAGRAM 4

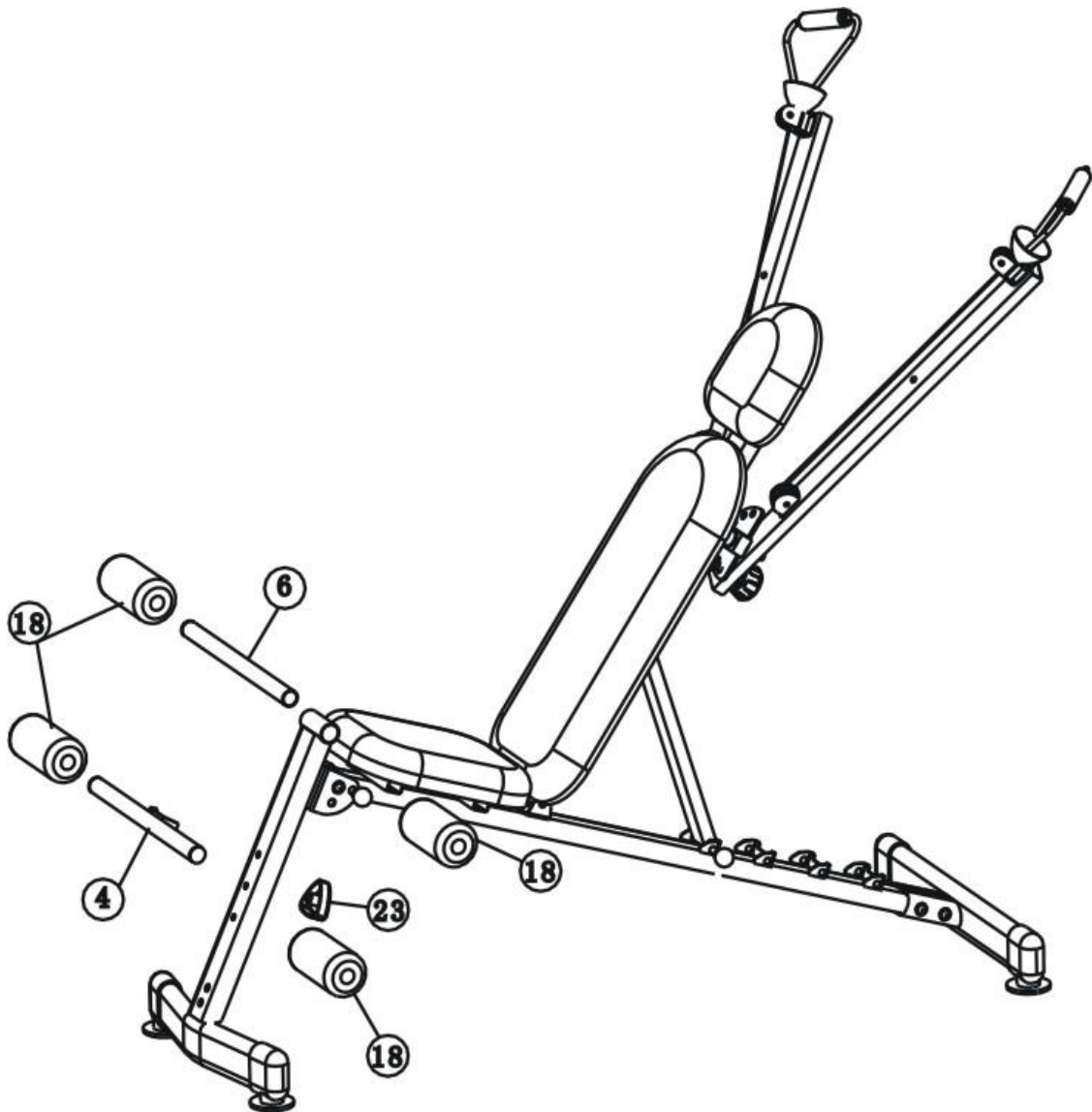

EXPLODED DIAGRAM

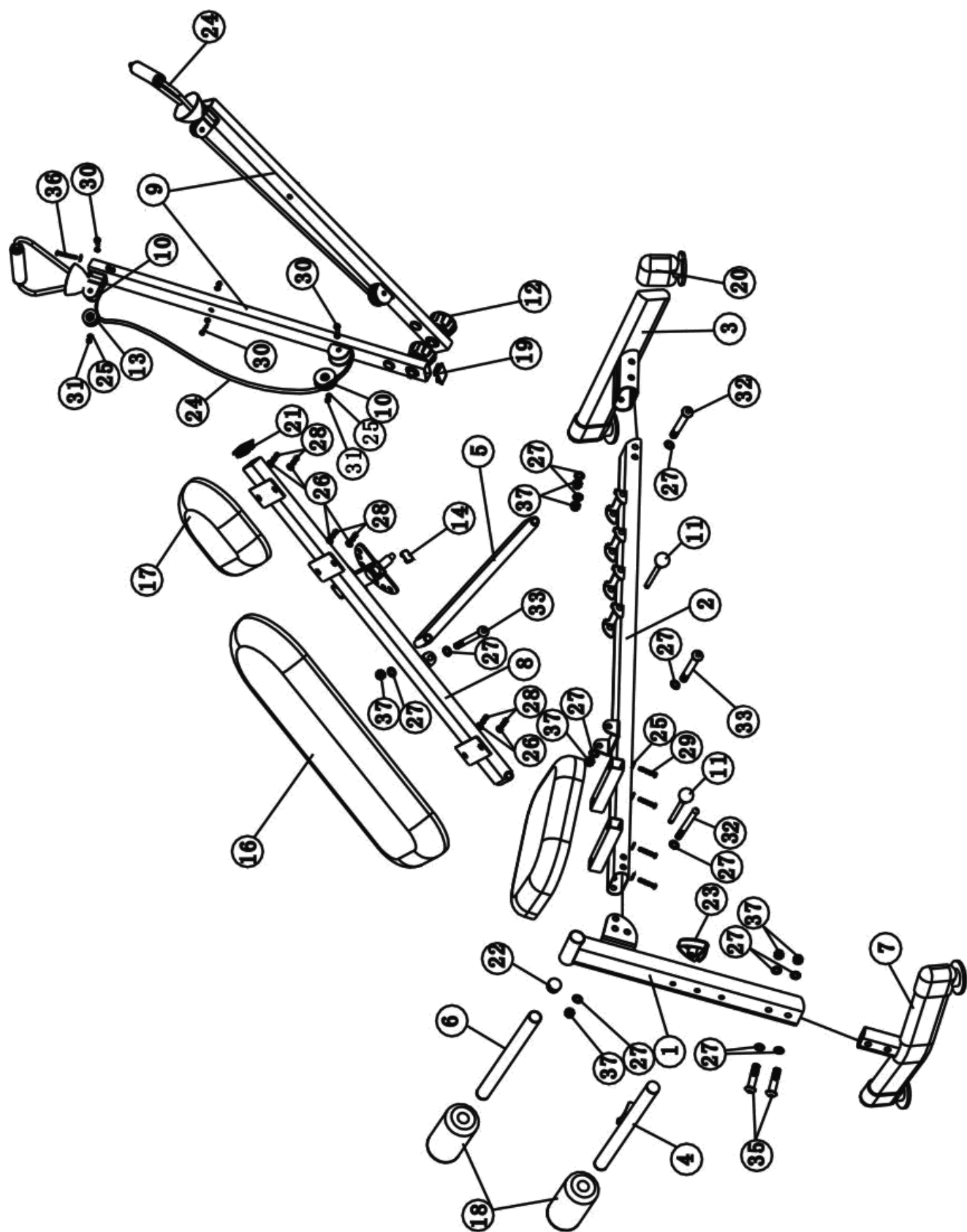

PARTS LIST

Key No.	Description	QTY	Key No.	Description	QTY
1	Front Vertical Support	1	20	30x70MM Foot	4
2	Seat Support Frame	1	21	25x50MM End Cap	1
3	Rear Base Support	1	22	Φ25MM End Cap	4
4	Short Foam Roll Tube	1	23	Knob	1
5	Backrest Incline Adjust Frame	1	24	Rubber Band	2
6	Long Foam Roll Tube	1	25	Φ6MM Washer	20
7	Front Base Support	1	26	Φ8MM Washer	6
8	Backrest Support Frame	1	27	Φ10MM Washer	16
9	Butterfly Frame	2	28	M8X16MM Allen Bolt	6
10	Pulley Bracket	2	29	M6X35MM Hex Bolt	4
11	Lock Pin	2	30	M6X28MM Allen Bolt	6
12	M18 Lock Knob	2	31	M6 Aircraft Nut	8
13	Pulley	4	32	M10X90MM Allen Bolt	3
14	20X30MM End Cap	2	33	M10X72MM Allen Bolt	2
15	Seat Pad	1			
16	Backrest Pad	1	35	M10X42MM Allen Bolt	2
17	Head Pad	1	36	M6X52MM Allen Bolt	2
18	Foam Roll	4	37	M10 Aircraft Nut	9
19	20x40MM End Cap	4			



GARLANDO SPA

Via Regione Piemonte, 32 - Zona Industriale D1

I 5068 - Pozzolo Formigaro (AL) - Italy

www.everfit.it - info@everfit.it